

PAR 56 TKF POWER E9602-LBI-15



EXTERIOR > UNDER WATER LIGHTS > PAR 56



FEATURES

Intended Use:	Exteriors
Installation:	Floor/wall mounting - to be installed EXCLUSIVELY IN WATER Max 40°C
Body/Structure:	Stainless steel body
Finish:	Satin stainless steel
Reflector/Optics:	PMMA LED Lens
Glass/Screen:	Clear tempered glass
Driver:	Not included; must be ordered separately

TECHNICAL DATA

Beam:	Concentric symmetrical 15°
Insulation class:	3
Weight:	1.3 kg
IP grade:	68
Glow wire:	850 °C
Lamp included:	Yes
LED type:	Power LED
Overall power:	65 W
Appliance flow:	4969 lm
Nominal duration:	50000
Color temperature:	5300 K
Color rendering index:	>80
Color consistency:	4 SDCM

LIGHT SOURCE: 1 x LED 65.00W 5040lm



NOTES

Maximum nighttime ambient temperature when the fitting is on not exceeding 50°C
Minimum nighttime ambient temperature when the fitting is on not lower than -20°C
Maximum daytime ambient temperature when the fitting is off not exceeding 60°C

TECHNICAL DRAWING

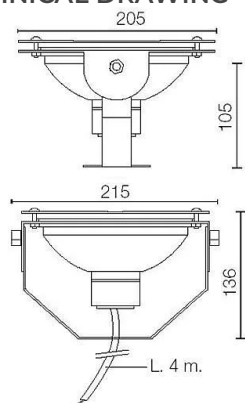

PHOTOMETRIC CURVES

