



## FEATURES

Intended Use:	Interior
Installation:	Recessed Ceiling
Recessed hole:	Recessed hole diam.156 mm. Ceiling thickness: 5-30 mm.
Fixing:	Steel wire springs
Body/Structure:	Die-cast aluminum body EN AB-47100
Painting:	Interior polyester powder coating
Finish:	White
Reflector/Optics:	99.8% pure aluminum reflector - Removable and adjustable optics
Glass/Screen:	Clear tempered glass
Driver:	Remote driver for LED, stabilized output 900mA dc

## TECHNICAL DATA

Tension:	220-240V 50/60Hz
Beam:	Symmetrical diffusing 30°
Current:	900mA
Insulation class:	2
Weight:	1.45 kg
IP grade:	20/44
Glow wire:	850 °C
Lamp included:	Yes
LED type:	COB LED
Overall power:	34.5 W
Appliance flow:	3644 lm
Nominal duration:	50.000 (h) L90 B20
Color temperature:	3000 K
Color rendering index:	>90
Color consistency:	3 SDCM

LIGHT SOURCE: 1 x LED 30.50W 4270lm



## NOTES

On request: led with color temperature 2700k, A

On request:

TECHNICAL DRAWING

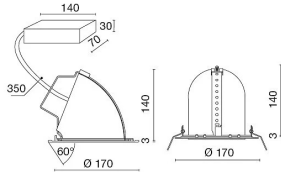

PHOTOMETRIC CURVES

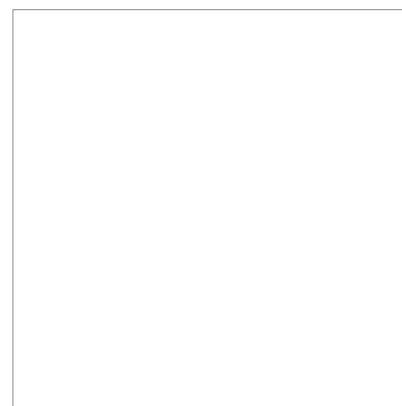
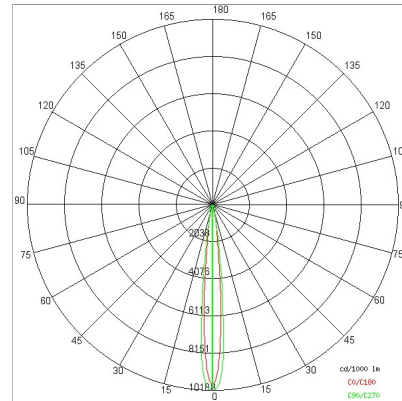

ACCESSORIES



1H emergency kit

INV 1052



Emergency kit

INV 1052-3



Compensation ring

122

## COMPANY

Side Spa has always been a benchmark in the manufacturing industry for its constant focus on product quality, assembly and sustainability of its items. The company is distinguished by its dedication to offering customers the highest quality products that meet needs and exceed expectations.

Side Spa pays the utmost attention to the quality of its products. Each stage of production undergoes rigorous quality control to ensure that only first-class items reach the market. By using high-quality materials and adopting state-of-the-art manufacturing processes, the company is able to offer products that stand the test of time and maintain their performance over the years. Quality is a top priority for Side Spa, which strives to meet the highest standards of excellence.