



## FEATURES

|                   |   |
|-------------------|---|
| Intended Use:     | Foodlighting,Interior   |
| Installation:     | Recessed Ceiling  |
| Recessed hole:    | ø 156 mm  |
| Fixing:           | Steel wire springs  |
| Body/Structure:   | Die-cast aluminum body EN AB-47100                              |
| Painting:         | Interior polyester powder coating                               |
| Finish:           | White   |
| Reflector/Optics: | 99.8% pure aluminum reflector - Removable and adjustable optics |
| Glass/Screen:     | Clear tempered glass  |
| Driver:           | Remote power supply for LED, stabilized output 700mA dc         |

## TECHNICAL DATA

|                        |                               |
|------------------------|-------------------------------|
| Tension:               | 220-240V 50/60Hz              |
| Beam:                  | Symmetric diffusive flood 30° |
| Current:               | 700mA                         |
| Insulation class:      | 2                             |
| Weight:                | 1.45 kg                       |
| IP grade:              | 20/44                         |
| Glow wire:             | 850 °C                        |
| Lamp included:         | Yes                           |
| LED type:              | COB LED                       |
| Overall power:         | 27 W                          |
| Appliance flow:        | 1750 lm                       |
| Nominal duration:      | 50.000 L80 B20                |
| Color temperature:     | 2400 K                        |
| Color rendering index: | >90                           |
| Color consistency:     | 3 SDCM                        |

LIGHT SOURCE: 1 x LED 24.00W 2075lm

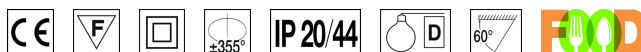

## NOTES

On request: dimmable version

TECHNICAL DRAWING

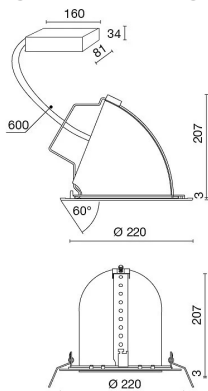

PHOTOMETRIC CURVES

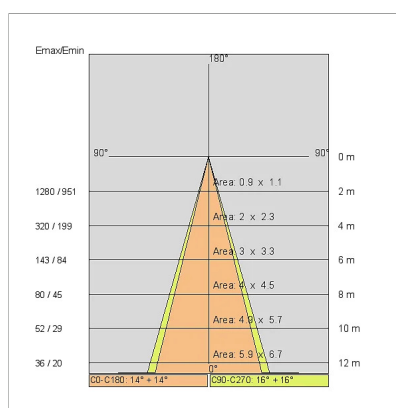
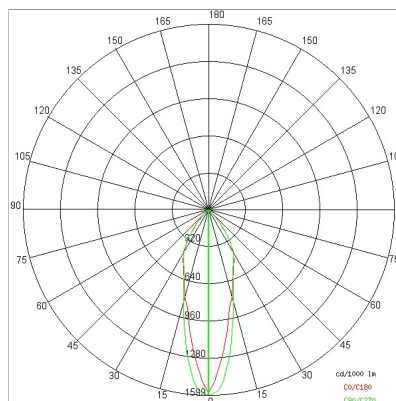

COMPANY

Side Spa has always been a benchmark in the manufacturing industry for its constant focus on product quality, assembly and sustainability of its items. The company is distinguished by its dedication to offering customers the highest quality products that meet needs and exceed expectations.

Side Spa pays the utmost attention to the quality of its products. Each stage of production undergoes rigorous quality control to ensure that only first-class items reach the market. By using high-quality materials and adopting state-of-the-art manufacturing processes, the company is able to offer products that stand the test of time and maintain their performance over the years. Quality is a top priority for Side Spa, which strives to meet the highest standards of excellence.